



Lien Kuan
Electro-Magnetic Lock

ELECTROMAGNETIC LOCK INSTALL INSTRUCTION

GL-270 / GL-271(Waterproof)

A. Specification & Electrical installation :

| | Lock Sensor | INPUT VOLTAGE | CURRENT DRAW | HOLDING FORCE | SURFACE MAGNET DIMENSION | STRIKE PLATE DIMENSION | HOLD DIMENSION | Body cover | L-Bracket material | Z-Bracket material |
|--------|-------------|----------------|----------------------------|---------------|--------------------------|------------------------|----------------|-----------------|--------------------|--------------------|
| GL-270 | NO | 12VDC TO 24VDC | 12VDC-500mA 24VDC-250mA | 600 LBS | 200×40×26 mm | 185×38×12 mm | 185 mm | Stainless steel | Stainless steel | Aluminum alloy |
| GL-271 | YES | | | | | | | | | |

B. Electric-Wiring connection instruction :

1. Build-in Surge Absorber protection.
2. Top quality coil isolation for high-voltage protection.

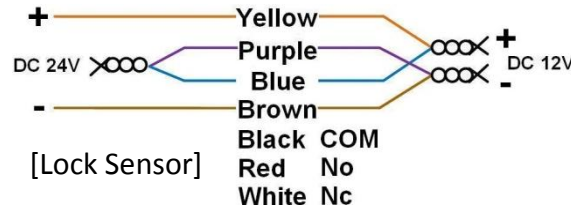

C. Installation step : (Refer to “F、 Assemble diagrams”)

1. The deviations between the lock and the strike plate should be under tolerance of 5mm, otherwise the lock sensor may provide false reading.
2. Make sure if your supply voltage is 12V or 24V DC and connect the wiring accordingly. Wrong connection or voltage will cause overheating and burn the electromagnet's coil.
3. Don't tighten the Flat-Head screw (M8) when installing strike plate. The thickness of the rubber washer (between the 2 metal washers) should be squeezed from 4mm to 2mm (As Fig a.& Fig b.) for allowing the plate to swing and achieve max holding force.
4. For in-swing installation, a suitable Z-Bracket should be ordered separately to suit this type of installation
5. Two oval ditched in the Z-Bracket, will allow adjusting the distance between the magnetic lock and strike plate. Secure the “L” plate by spring washers as shown in Fig c.
6. Drill two holes of 6~8mm in the door in an accurate position for the two pins to hold the strike plate in place and avoid deviation (As in Fig d.)

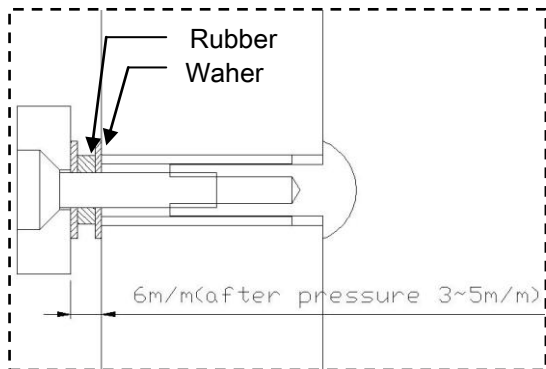

Fig a. There is a rubber between two Washers.

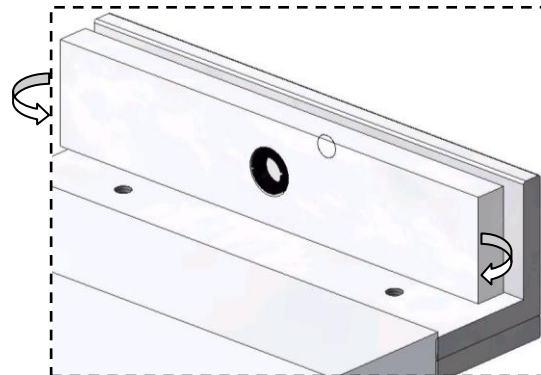

Fig b. Don't be tight Flat-Head screw (M8) When install strike plate. (Prevent strike plate couldn't 100% close the magnetic.)

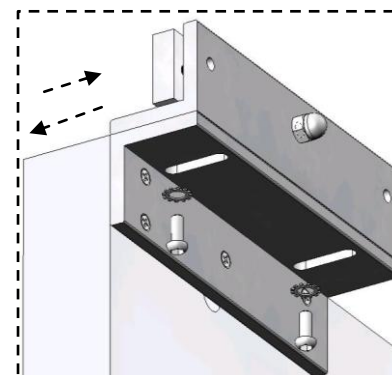

Fig c. Put two Anti-sliding seals(M8) and screws(M8) to fixed the Z-Bracke.

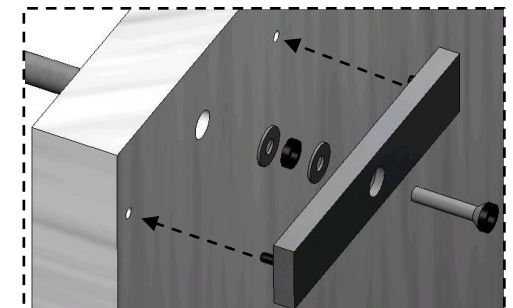
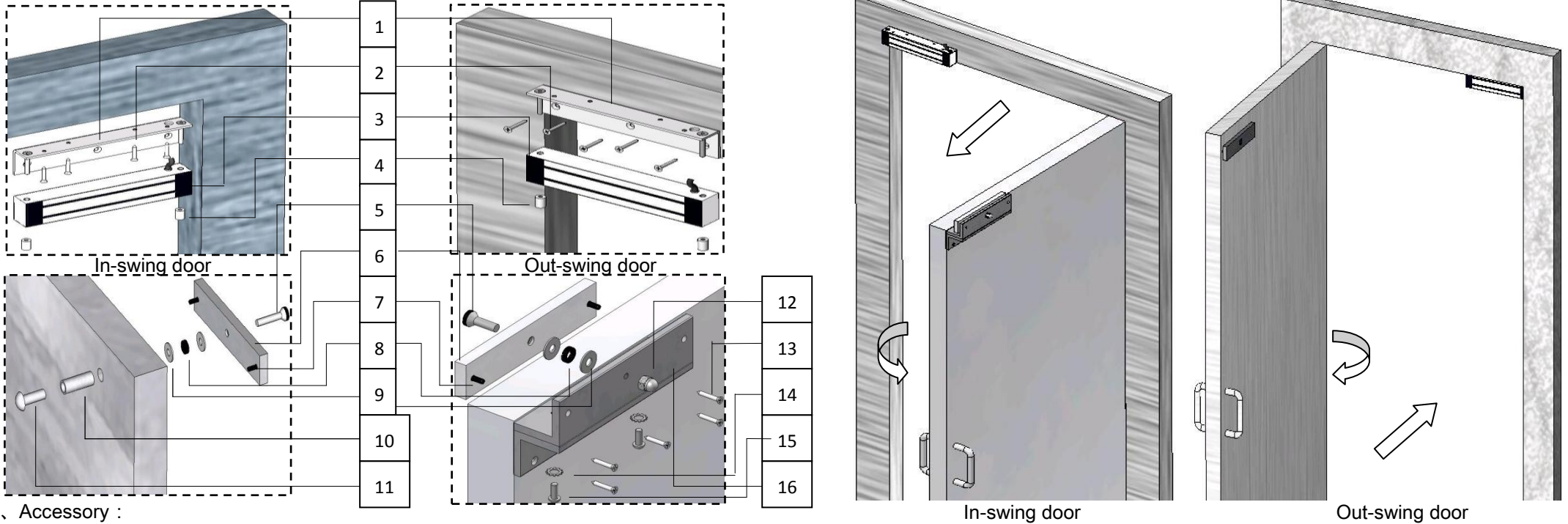

Fig d. It'll fixed two pins of strike plate and avoid deviation too much.

D、Out-swing door & In-swing door diagram :



E、Accessory :

| | 1 | 2 | 3 | 4 | 5 | 6 | 7 | 8 | 9 | 10 | 11 | 12 | 13 | 14 | 15 | 16 |
|---------------|----------------|------------|--------------|------------|-----------------|--------------|-------|--------|--------|------|---------------------|-----|--------------|-------------------|-------|--------------|
| Name | L-Bracket | Screw | Body | Screw tube | Flat-Head screw | Strike plate | Pin | Rubber | Washer | Tube | Mushroom head screw | Nut | Screw | Anti-sliding seal | Screw | Z-Bracket |
| Amount | 1 | 5 | 1 | 2 | 1 | 1 | 2 | 1 | 2 | 1 | 1 | 1 | 5 | 2 | 2 | 1 |
| Specification | 200×42.5×28 mm | 5/32"×3/4" | 200×40×26 mm | M5 | M8 | 185×38×12 mm | Ø5×16 | | 5/16" | | M8 | M8 | 3/16"×1-1/4" | M8 | M8 | 190×50×50 mm |

F、Assemble diagrams :

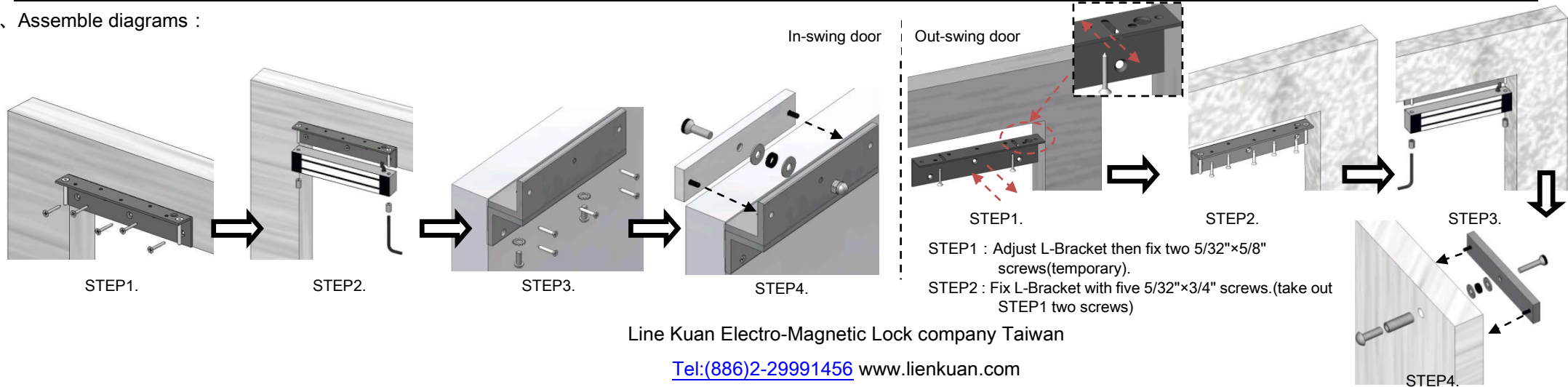

Line Kuan Electro-Magnetic Lock company Taiwan

Tel:(886)2-29991456 www.lienkuan.com