

SPECIFICATION & JUMPER SETTING

INPUT VOLTAGE	CURRENT DRAW	HOLDING FORCE	SURFACE MAGNET DIMENSION	STRIKE PLATE DIMENSION
12 TO 24 VDC	12VDC-200mA 24VDC-100mA	180LBS(80KG)	100x38x38 mm	75x32x52 mm

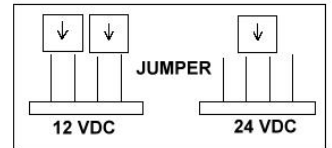

Assembly

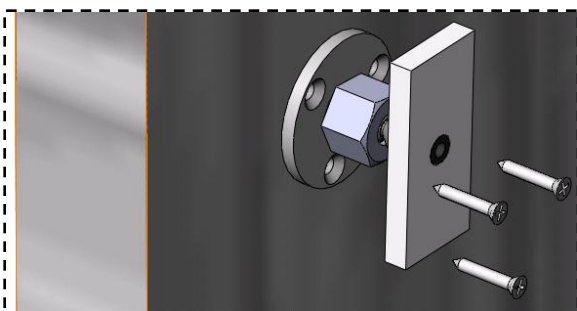
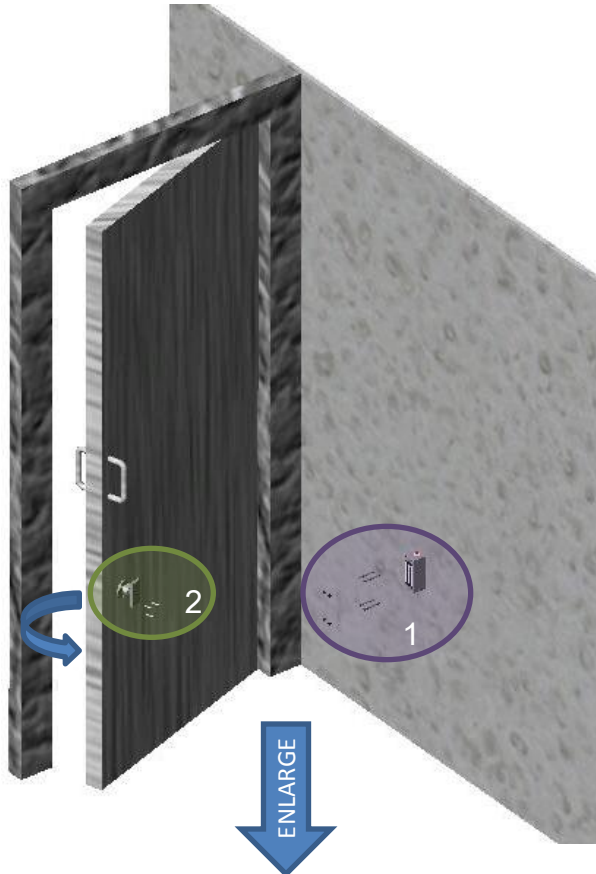

ENLARGE 2

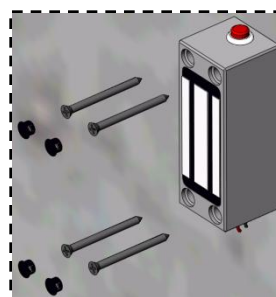

ENLARGE 1